



Paul Pieri



Wantage

£350,000

Oxfordshire OX12 7EG





- Refurbishment opportunity in desirable location
- No onward chain
- Six bedrooms
- Garage and driveway
- Large storeroom
- Generous garden

Wantage

£350,000

A fantastic refurbishment opportunity is offered for sale with no onward chain. This generous six bedroom, semi-detached house located in a desirable road in Wantage is in need of updating, but will make a great family home. The property benefits from a garage, larger than average living room diner and good sized rear garden. The property is approached by a brick driveway that leads up to the front porch. Internally, the entrance hall leads through to the living room diner that has patio doors overlooking the rear garden. Off of the living room, the well-proportioned separate kitchen with serving hatch has a door that leads to the thirty foot store room, which also has a WC and hand basin. From the entrance hall, stairs rise to the first floor where four of the bedrooms and family bathroom can be found. The loft conversion leads to the further two bedrooms. The rear garden benefits from a patio, is mostly laid to lawn and can be accessed by a side gate.

For more information or to arrange a viewing please contact:

Wantage
3b Newbury Street
Wantage
Oxfordshire, OX12 8BU

Sales
Tel 01235 763611
Email sales@paulpieri.co.uk
Web www.paulpieri.co.uk



Ground Floor

Approx. 76.6 sq. metres (824.9 sq. feet)

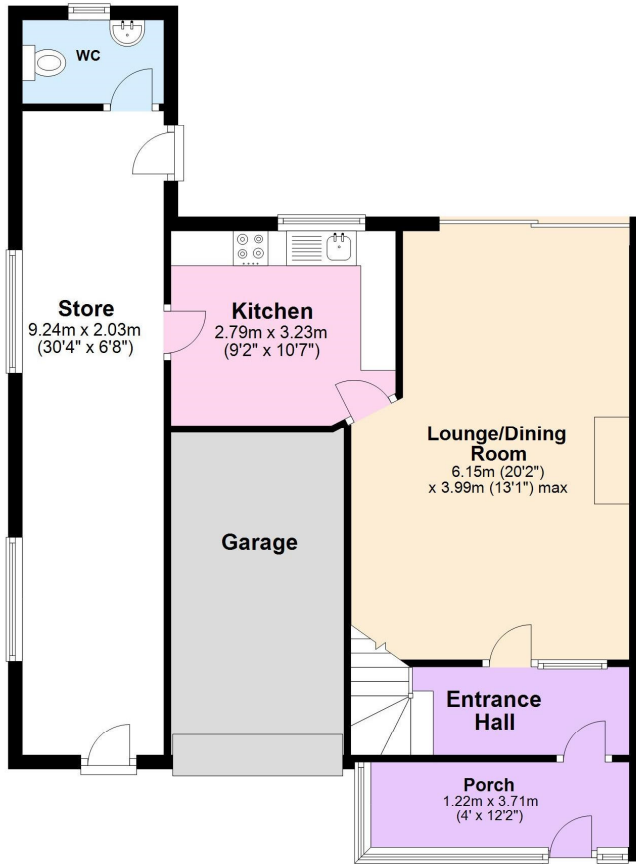

First Floor

Approx. 48.5 sq. metres (522.4 sq. feet)

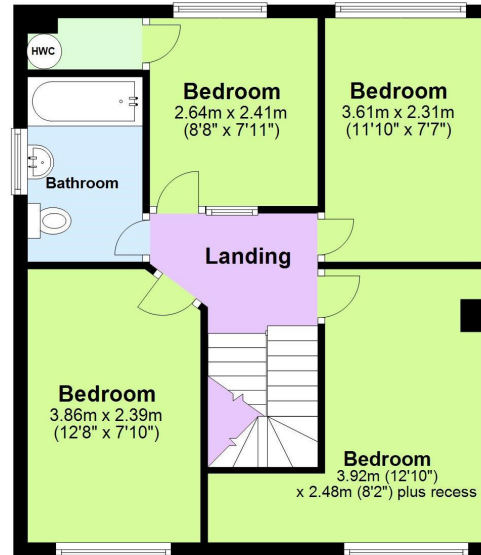

Second Floor

Approx. 19.7 sq. metres (211.9 sq. feet)

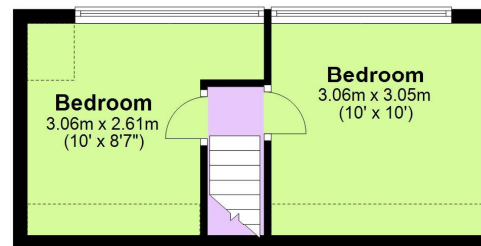

Total area: approx. 144.9 sq. metres (1559.2 sq. feet)

Every attempt has been made to ensure the accuracy of this floor plan. Measurements of doors, windows and rooms are approximate for indicative purposes only. No responsibility is taken for any error, omission, or misstatement. Specifically, no guarantee is given on the total square footage of the property if provided and figures are given for guidance purposes only and must not be relied on as a basis of valuation.
Plan produced using PlanUp.



Score	Energy rating	Current	Potential
92+	A		
81-91	B		
69-80	C		77 C
55-68	D		
39-54	E		
21-38	F	38 F	
1-20	G		

Paul Pieri Estate Agents Limited. Registered in England and Wales. Registered Number 10485522.
Registered address Maple Suite, 10-12 High Street, Hungerford, Berkshire, United Kingdom, RG17 0DN.
Directors: Paul Pieri & Lorna Pieri

For more information or to arrange a viewing please contact:

Wantage
3b Newbury Street
Wantage
Oxfordshire, OX12 8BU

Sales
Tel 01235 763611
Email sales@paulpieri.co.uk
Web www.paulpieri.co.uk



Whilst every attempt has been made to ensure the accuracy of the floor plans contained here, measurements of doors, windows and rooms are approximate and no responsibility is taken for any error, omission or mis-statement. These plans are for representation purposes only as defined by RICS Code of Measuring Practice and should be used as such by any prospective purchaser. The services, systems and appliances listed in this specification have not been tested by Paul Pieri Estate Agents Limited and no guarantee as to their operating ability or their efficiency can be given.